

FAG

**2212-K-2RS-TVH-C3**

Self-aligning ball bearing

Schaeffler ID:  
0389043810030Self-aligning ball bearing 22..-K-2RS-TVH,  
tapered bore taper 1:12, seals, plastic  
cage

## Technical information

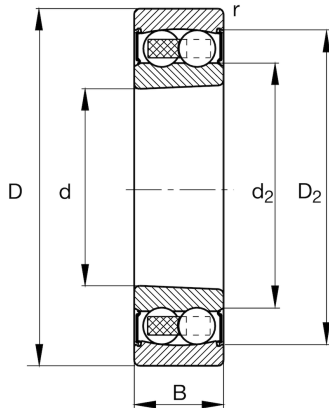

## Main Dimensions &amp; Performance Data

d	60 mm	Bore diameter
D	110 mm	Outside diameter
B	28 mm	Width
$r_{\min}$	1,5 mm	Minimum chamfer dimension
$C_r$	30.500 N	Basic dynamic load rating, radial
$C_{0r}$	11.500 N	Basic static load rating, radial
$C_{ur}$	730 N	Fatigue load limit, radial
$n_G$	3.450 1/min	Limiting speed
	1,023 kg	Weight

## Dimensions

$D_2$	99,5 mm	Caliber diameter outer ring
$d_2$	70,4 mm	Caliber diameter inner ring

## Mounting dimensions

$d_{a \min}$	69 mm	Minimum diameter shaft shoulder
$d_{a \max}$	75 mm	Maximum diameter shaft shoulder
$D_{a \max}$	101 mm	Maximum diameter of housing shoulder
$d_{b \min}$	64 mm	Minimum cavity diameter of the sleeve
$B_{a \min}$	5 mm	Minimum cavity width of the sleeve
$r_{a \max}$	1,5 mm	Maximum fillet radius

## Calculation factors

e	0,18	Limiting value of $F_a/F_r$ for the applicability of diff. Values of factors X and Y
$Y_1$	3,47	Dynamic axial load factor
$Y_2$	5,37	Dynamic axial load factor
$Y_0$	3,64	Static axial load factor

## Additional information

H312	Adapter sleeve
------	----------------

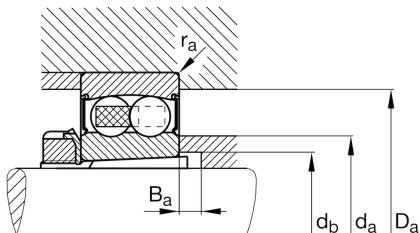
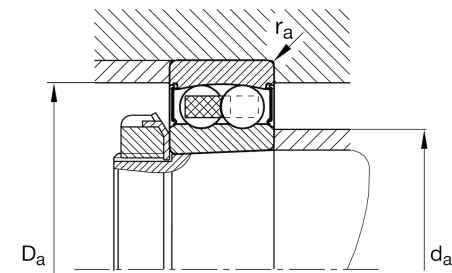

**Temperature range**

$T_{\min}$	-20 °C	Operating temperature min.
$T_{\max}$	100 °C	Operating temperature max.